

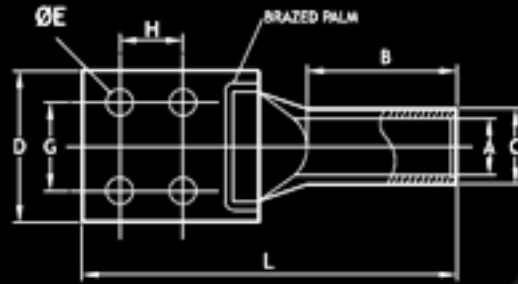

Star Extrusion

COMPRESSION CABLE LUGS BRAZED PALM FOR TRANSFORMER



MATERIAL : E-COPPER
 FINISH : ELECTRO-TINNED
 FEATURES : WITH / WITHOUT INSPECTION HOLE

COMPONENT NO	CABLE SIZE mm ²	STUD HOLE ØE	DIMENSIONS IN mm							PER BOX
			A	C	D	G	H	B	L	
	185	8.5	18.5	23.5	60	35	25	31	121	15
		10.5								
	240	8.5	21	26.5	60	35	25	35	126	10
		10.5								
	300	8.5	23.5	30	60	35	25	44	137	5
		10.5								
	400	8.5	28.5	36.5	60	35	25	40	139	3
		10.5								