

SOLDERING TYPE TUBULAR LUGS

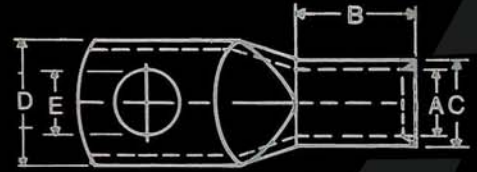

MATERIAL : High conductivity sealess copper tube to BS-2874 - C 101.

FINISH : Uniformly electro-tin plated for operating temperatures upto 150° C. Also available in Electrolytic Nickel plated for the connectors operating upto 350° C.

COMPONENT NO.	BSS REF NEW	CABLE SIZE SQ. MM.	STUD HOLE E	DIMENSIONS (MM)					
				A	C	D	F	B	J
SI - 1T	1T	6	5.5	4.4	6	9	1.6	10	24
SI - 2T	2T	16	6.6	6	8	11	2	13	31
SI - 5T	5T	25	9	7.6	10	14	24	13	41
SI - 6T	6T	35	9	9.6	12	17	24	16	45
SI - 7T	7T	50/70	11	12	16.6	23	46	19	55
SI - 9T	9T	95	14	14.3	19.5	28	5.2	22	62
SI - 10T	10T	120	14	16.7	22.5	32	5.8	29	78
SI - 11T	11T	150/185	14	20.6	27.8	40	7.2	32	86
SI - 13T	13T	240	18	23.8	31	45	7.2	38	100
SI - 14T	14T	300	18	26.2	34.2	49	8	44	111
SI - 15T	15T	400/500	22	31.7	40.9	59	9.2	48	121
SI - 19T	19T	625	26	36.5	46.1	67	9.6	56	139