

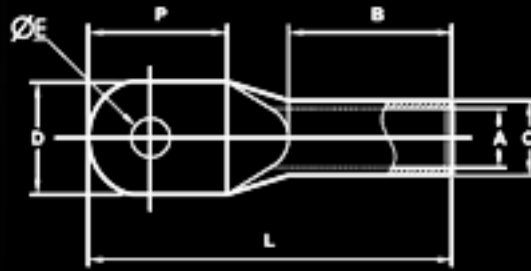

Star Extrusion

COMPRESSION CABLE LUGS, N-SERIES



MATERIAL : E-COPPER

FINISH : ELECTRO-TINNED

FEATURES : WITH OR WITHOUT INSPECTION HOLE

COMPONENT NO	CABLE mm ²	STUD HOLE ØE	DIMENSIONS IN mm						PER BOX	
			A	C	D	P	B	L		
	6	5.2	3.8	5.5	10	14	9	28	1000	
		6.2								
	10	5.2	4.5	6.2	11	15	9	28	1000	
		6.2			16					25
		10.5								
	16	6.2	5.5	7	12	16	12	36	500	
		8.2			16					24
		10.5								
		13								
	25	6.2	6.8	8.8	13	16	12	37	300	
		8.2			16					25
		10.5								
		13								
	35	6.2	8.2	10.6	15	20	18	43	200	
		8.2			17					26
		10.5								
		13								
	50	6.2	9.5	12.4	18	23	16	49	150	
		8.2								
		10.5								
		13								
	70	8.2	11.2	14.7	21	25	20	55	100	
		10.5								
		13								
		14								
	95	10.5	13.5	17.4	25	27	23	62	75	
		13								33
		14								
		17								

	120	10.5	15	19.4	28	28	28	72	50
		13							
		14							
		17							
		21				33		77	
	150	10.5	16.5	21	30	32	30	75	40
		13							
		17							
		21							
	185	10.5	18.5	23.5	34	38	31	85	30
		13							
		14							
		17							
		21							
	240	13	21	26.5	38	43	35	95	20
		17							
		21							
	300	17	23.5	30	43	47	44	110	15
		21							
	400	17	28.5	36.5	52	48	40	112	10
		21							
	500	17	30	37	55	50	75	148	5
		21							
	630	17	34	41	60	50	70	148	5
		21							