

TINNED COPPER CABLE TERMINAL ENDS (LUGS)

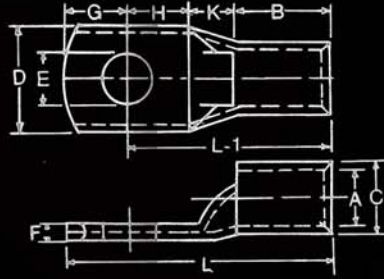

MATERIAL : High conductivity seamless copper tube to BS 2874-C 101 ASTM B 152 - C 11000

FEATURES : Provided with inspection window, thus ensuring full conductor insertion.

Entrance chamfered to facilitate cable entry smoothly and easily

High wall thickness, giving termination, excellent electrical and mechanical properties.

Simple installation with readily available tools.

FINISH : Uniformly Electro-tin-plated for operating temperatures upto 150°C, For operating temperatures above 150°C upto 3500 Electrolytic nickel plated is suggested.

COMPONENT NO.	CABLE SIZE SQ. MM.	STUD HOLE E	DIMENSIONS (MM)								
			A	C	D	F	G	H	K	B	L
SI - 1.5 - 4	1.5	4.2	1.8	3.7	8	1	4	5	2	5	16
SI - 1.5 - 5	1.5	5.2	1.8	3.7	8	1	4	5	2	5	16
SI - 1.5 - 6	1.5	6.5	1.8	3.7	10	0.8	5	6	2	5	18
SI - 2.5 - 4	2.5	4.2	2.4	4	8	1	4	5	2	7	18
SI - 2.5 - 5	2.5	5.2	2.4	4	10	0.8	5	6	2	7	20
SI - 2.5 - 6	2.5	6.5	2.4	4	10	0.8	5	6	2	7	20
SI - 2.5 - 8	2.5	8.2	2.4	4	11	0.7	6.5	8.5	2	7	24
SI - 4 - 4	4	4.2	3.1	4.8	10	1	5	6	2	7	20
SI - 4 - 5	4	5.2	3.1	4.8	10	1	5	6	2	7	20
SI - 4 - 6	4	6.5	3.1	4.8	10	1	5	6	2	7	20
SI - 4 - 8	4	8.2	3.1	4.8	12	0.8	6.5	8.5	2	7	24
SI - 6 - 4	6	4.2	3.3.8	5.5	10	1.2	5	6	3	9	23
SI - 6 - 5	6	5.2	3.8	5.5	10	1.2	5	6	3	9	23
SI - 6 - 6	6	6.5	3.8	5.5	12	1	6	9	3	9	27
SI - 6 - 8	6	8.2	4.5	5.5	12	1	6	9	3	9	27
SI - 6 - 10	6	10.2	4.5	5.5	16	0.8	6	11	3	9	32
SI - 10 - 5	10	5.2	4.5	6.2	12	1.2	9	7	3	10	25
SI - 10 - 6	10	6.2	4.5	6.2	12	1.2	6	7	3	10	25
SI - 10 - 8	10	8.2	4.5	6.2	12	1.2	6	9	3	12	27
SI - 10 - 10	10	10.5	4.7	6.2	16	1.4	8.5	10.5	3	12	32
SI - 10 - 12	10	12.7	5.4	7.1	18	2.4	10	1.3	4	12	37
SI - 16 - 5	16	5.2	5.4	7.1	12	1.4	7	7	4	12	30
SI - 16 - 6	16	6.5	5.4	7.1	12	1.4	7	7	4	12	30
SI - 16 - 8	16	8.5	5.4	7.1	12	1.4	7	9	4	12	32
SI - 16 - 10	16	10.5	7.1	19	1.8	10	10	10	4	12	36
SI - 16 - 12	16	12.7	7.1	19	1.8	12	12	12	4	12	40

SI - 20 - 8	20	8.4	6	7.7	12	1.7	7	9	4	12	32
SI - 25 - 5	25	5.2	6.8	8.8	13	2	7	7	4	12	30
SI - 25 - 6	25	6.5	6.8	8.8	13	2	7	7	4	12	30
SI - 25 - 8	25	8.4	6.8	8.8	16	1.6	10	11	4	12	37
SI - 25 - 10	25	10.2	6.8	8.8	18	1.2	10	11	4	12	37
SI - 25 - 12	25	12.7	6.8	8.8	18	1.4	12	13	4	12	41
SI - 35 - 5	35	5.2	8.2	10.6	15	2.4	9	9	5	12	35
SI - 35 - 6	35	6.5	8.2	10.6	15	2.4	9	9	5	12	35
SI - 35 - 8	35	8.4	8.2	10.6	15	2.4	9	9	5	12	35
SI - 35 - 10	35	10.5	8.2	10.6	18	2	11	11	5	10	38
SI - 35 - 12	35	13	8.2	10.6	20	1.8	13	13	6	15	45
SI - 50 - 6	50	6.5	9.5	12.4	18	2.9	11	11	6	16	43
SI - 50 - 8	50	8.2	9.5	12.4	18	2.9	11	11	6	16	43
SI - 50 - 10	50	10.5	9.5	12.4	18	2.9	11	11	6	16	43
SI - 50 - 12	50	13	9.5	12.4	18	2.9	11	11	7	16	43
SI - 70 - 8	70	8.2	11.2	14.7	21	3.5	13	13	7	18	50
SI - 70 - 10	70	10.5	11.2	14.7	21	3.5	13	13	7	18	50
SI - 70 - 12	70	13	11.2	14.7	21	3.5	13	13	7	18	50
SI - 70 -14	70	14.7	11.2	14.7	24	2.2	16	16	7	18	57
SI - 70 - 16	95	17	13.5	14.7	24	2.2	16	16	9	18	57
SI - 95 - 10	95	10.5	13.5	17.4	25	3.9	13	13	9	20	55
SI - 95 - 12	95	13	13.5	17.4	25	3.9	13	13	9	20	55
SI - 95 - 14	120	14.7	15	17.4	25	3.9	13	13	10	22	55
SI - 120 - 8	120	8.2	15	19.4	28	4.4	14	14	10	22	60
SI - 120 - 10	120	10.5	15	19.4	28	4.4	14	14	10	22	60
SI - 120 - 12	120	13	15	19.4	28	4.4	14	14	10	22	60
SI - 120 - 16	150	17	16.5	19.4	28	4.4	16	16	11	26	64
SI - 150 - 8	150	8.2	16.5	21.2	30	4.7	16	16	11	26	69
SI - 150 - 10	150	10.5	16.5	21.2	30	4.7	16	16	11	26	69
SI - 150 - 12	150	13	16.5	21.2	30	4.7	16	16	11	26	69
SI - 150 - 14	150	14.7	16.5	21.2	30	4.7	16	16	11	26	69
SI - 150 - 16	185	17	18.5	21.2	30	4.7	16	16	12	32	78
SI - 185 - 10	185	10.5	18.5	23.5	34	5	17	17	12	32	78
SI - 185 - 12	185	13	18.5	23.5	34	5	17	17	12	32	78
SI - 185 - 14	185	14.7	18.5	23.5	34	5	17	17	12	32	78
SI - 185 - 16	240	17	21	23.5	34	5.5	17	17	14	38	92
SI - 240 - 10	240	10.5	21	26.5	38	5.5	20	20	14	38	92
SI - 240 - 12	240	13	21	26.5	38	5.5	20	20	14	38	92
SI - 240 - 14	240	14.7	21	26.5	38	5.5	20	20	14	38	92
SI - 240 - 16	240	17	21	26.5	38	5.5	20	20	14	38	92
SI - 240 - 20	300	21	23.5	26.5	38	6.5	20	22	15	42	101
SI - 300 - BL	300	BL	23.5	30	43	6.5	22	22	15	42	101
SI - 300 - 10	300	10.5	23.5	30	43	6.5	22	22	15	42	101
SI - 300 - 12	300	13	23.5	30	43	6.5	22	22	15	42	101
SI - 300 - 14	300	14.7	23.5	30	43	6.5	22	22	15	42	101
SI - 300 - 16	300	17	23.5	30	43	6.5	22	22	15	42	101
SI - 300 - 20	400	21	28.5	36.5	43	8	22	26	18	44	114
SI - 400 - BL	400	BL	28.5	36.5	50	8	26	26	18	44	114
SI - 400 - 12	400	13	28.5	36.5	50	8	26	26	18	44	114
SI - 400 - 14	400	14.7	28.5	36.5	50	8	26	26	18	44	114
SI - 400 - 20	400	17	28.5	36.5	50	8	26	26	18	44	114
SI - 500 - BL	500	21	30	39	50	9	26	26	20	48	124
SI - 500 - 14	500	BL	30	39	56	9	28	28	20	48	124
SI - 500 - 16	500	14.7	30	39	56	9	28	28	20	48	124
SI - 500 - 20	500	17	30	39	56	9	28	28	20	48	124
SI - 500 - 20	550	21	31.7	41.4	56	9.7	28	28	20	52	132
SI - 630 - BL	630	21	35	45	60	10	30	30	22	56	144
SI - 630 - 16	630	BL	35	45	65	10	33	33	22	56	144
SI - 630 - 20	630	21	35	45	65	10	33	33	22	56	144
SI - 630 - 26	630	27	35	45	65	10	33	33	22	56	144
SI - 800 - BL	800	BL	39	50.6	65	11.6	33	40	17	78	170
SI - 800 - 16	800	17	39	50.6	73	11.6	40	40	17	78	170
SI - 800 - 20	800	21	39	50.6	73	11.6	40	40	17	78	170
SI - 1000 - BL	1000	BL	43	56.2	73	13.2	45	45	20	90	200
SI - 1000 - 16	1000	17	43	56.2	81	13.2	45	45	20	90	200
SI - 1000 - 20	1000	21	43	56.2	81	13.2	45	45	20	90	200
SI - 1000 - 26	1000	27	43	56.2	81	13.2	45	45	20	90	200