

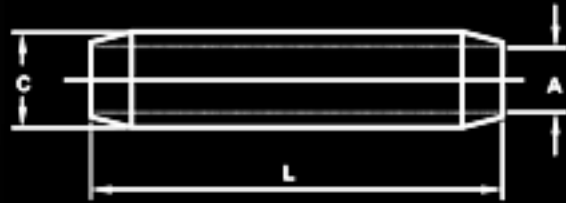

Star Extrusion

COMPRESSION THROUGH JOINTS (NON TENSION)



MATERIAL : E-COPPER
FINISH : UNTINNED
APPLICATION : UP TO 33 KV

COMPONENT NO	CABLE mm ²	DIMENSIONS IN mm			PER BOX
		A	C	L	
	25	7	12.5	60	50
	35	8.2	12.5	60	50
	50	10	14.5	65	50
	70	11.5	16.5	65	40
	95	13.5	19	90	25
	120	15.5	21	90	25
	150	16.5	23.5	105	15
	185	19	25	105	15
	240	21.5	28.5	125	5
	300	23.5	31.5	125	5
	400	27.5	37.5	160	5

*TINNING ON REQUEST